

ILC-10-N New

C.G.    ENG.    MFG. ENG.    PROD. CONT.    PRESS    POLISHING    TOOL ROOM    MILLING    ASSEMBLY    CUSTOMER

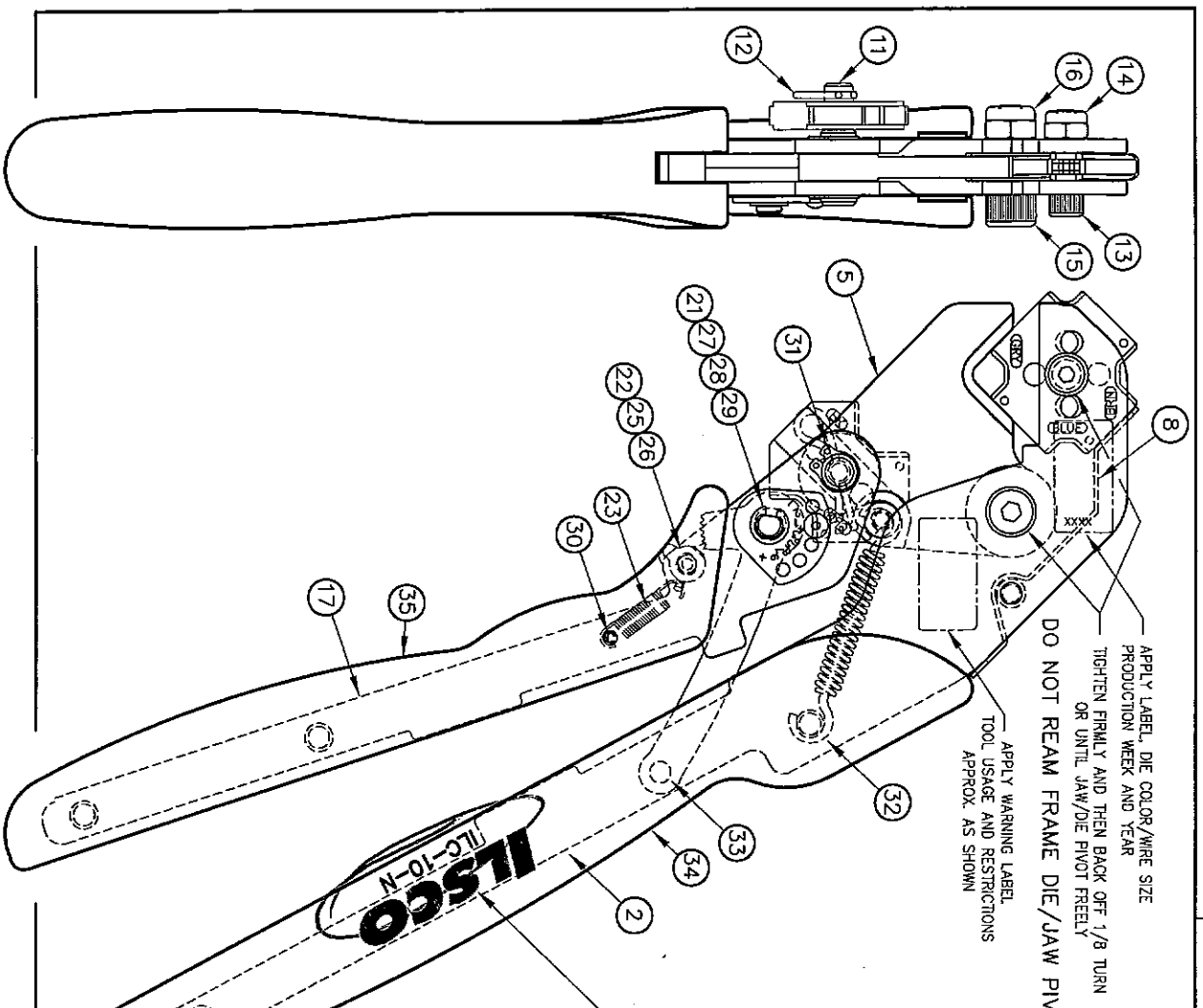

APPLY LABEL, DIE COLOR/WIRE SIZE  
PRODUCTION WEEK AND YEAR  
TIGHTEN FIRMLY AND THEN BACK OFF 1/8 TURN  
OR UNTIL JAW/DIE PIVOT FREELY  
DO NOT REAM FRAME DIE/JAW PIVOT HOLES!  
APPLY WARNING LABEL  
TOOL USAGE AND RESTRICTIONS  
APPROX. AS SHOWN

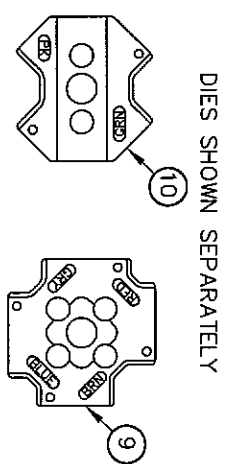

DIES SHOWN SEPARATELY

DIE PART NUMBER	DIE INDEX NUMBER	GAGE DIA. (IN.) MIN. - MAX.	WIRE SIZE
SP 1267-01	RED	.178	.200
	BLUE	.220	.238
	GRY	.256	.275
	BRN	.325	.347
SP 1267-02	GRN	.348	.367
	PK	.414	.435

PAD PRINT LOGO

HEAT TREATED FRAME COMPONENTS.  
HEAT TREATED DIES.  
BLACK OXIDE FINISH ON FRAME & DIES.  
COLORED PAINT FILL ON DIE INDENTS  
FULL-CYCLE RATCHET CONTROLLED RELEASE.  
RATCHET SET TO RELEASE WHEN A 15-30 LB.  
LOAD IS APPLIED APPROX. 1 3/4" FROM END.  
OF HANDLES WITH DIES POSITIONED AS SHOWN.  
YELLOW MOLDED TEXTURED PLASTIC GRIPS WITH  
PAD PRINTED LOGO (BLACK INK).

NOTE: FORMERLY L 5020

REV	DESCRIPTION	DATE	BY	APPD.	CHECKED	SCALE	ANGLES ±	TOLERANCES	PART NAME
A	ADDED SHOULDER BOLT & NUT AT JAW PIVOT TO ELIMINATE JAW SPREADING UNDER LOAD AND STRENGTHEN TO LOCKER AND PIVOT	11/12/01	CJG			1:1			ILSCO-4290 ROTARY TOOL
B	REVISED LOGO AND LOCATION	2/28/02	CJG						SP 2000-001C
C	ADDED DIE COLOR/WIRE SIZE/PART COLOR LABEL ADDED WARNING/TOOL USAGE LABEL	9/25/01	CJG						
	EXP. RELEASE	3/15/00							
	FINAL RELEASE	9/8/07							

ROSTRA TOOL COMPANY  
BRANFORD, CONNECTICUT 06405

DO NOT SCALE DRAWING